



Putting in your earmould

Step 1



Step 2



Step 3



Step 4



Step 5



Incorrect



Putting in your earmould

Step 1



Step 2

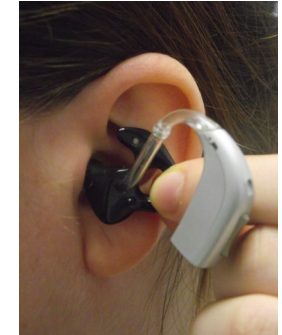

Step 3



Step 4

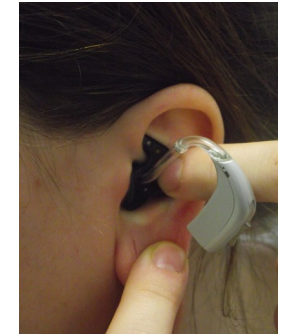

Step 5



Incorrect





Cleaning your ear mould

Step 1

- Twist and pull here:

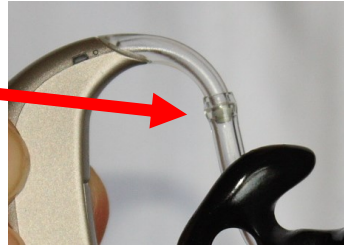

Step 2

- Wash in warm water with hand or face soap. Dental cleaner rods can be used to help remove wax.
- Leave in warm place, ensure water is cleared from tubing.



Step 3

- Push tubing into hearing aid

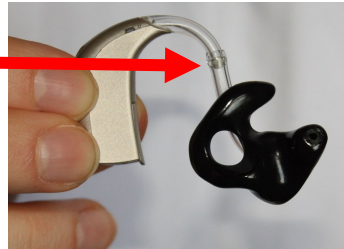

- **Incorrect** connection

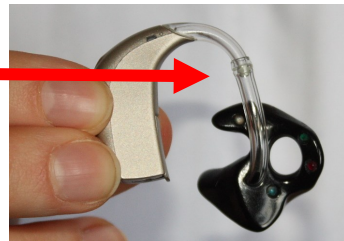

Every **6 months** ring the audiology department at Yeovil on:
01935 384249 to book an appointment to have service on aid.



Cleaning your ear mould

Step 1

- Twist and pull here:

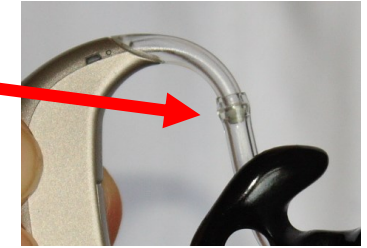

Step 2

- Wash in warm water with hand or face soap. Dental cleaner rods can be used to help remove wax.
- Leave in warm place, ensure water is cleared from tubing.



Step 3

- Push tubing into hearing aid

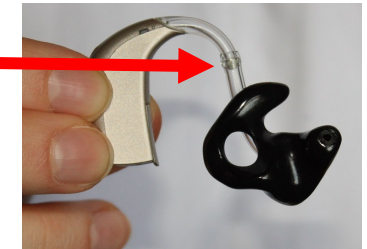

- **Incorrect** connection

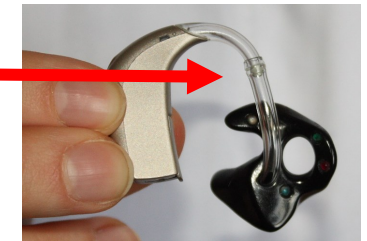

Every **6 months** ring the audiology department at Yeovil on:
01935 384249 to book an appointment to have service on aid.